

# Neria™ infusion sets

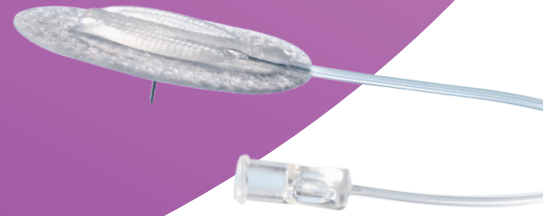

The **Neria™** infusion set is a steel needle infusion set inserted at a 90-degree angle. The Neria™ infusion set has a built-in adhesive and wings to hold on to for insertion.

## Product specifications

<b>Cannula</b>	Stainless steel
<b>Insertion angle</b>	90 degrees (straight in)
<b>Disconnection</b>	No
<b>Adhesive</b>	Built-in, non-woven polyester, acrylic adhesive

Gauge size	Needle lengths	Tubing lengths	Priming volumes
G27	6, 8, 10 and 12 mm*	60, 80 and 110 cm	60 cm ~ 0.10 ml 80 cm ~ 0.12 ml 110 cm ~ 0.16 ml
G29	6, 8, and 10 mm	60, 80 and 110 cm	60 cm ~ 0.07 ml 80 cm ~ 0.09 ml 110 cm ~ 0.11 ml

The Neria™ infusion sets are sold in boxes containing 10 sets.

\*12 mm needle length is only available with a 80 cm tubing.

# Neria™ infusion set user steps

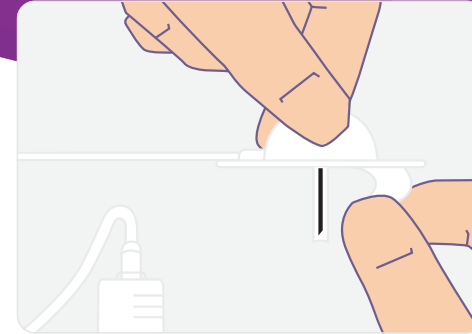

**Step 1.**  
Prime the tubing according to pump manufacturer's instructions for use and remove the adhesive backing paper.

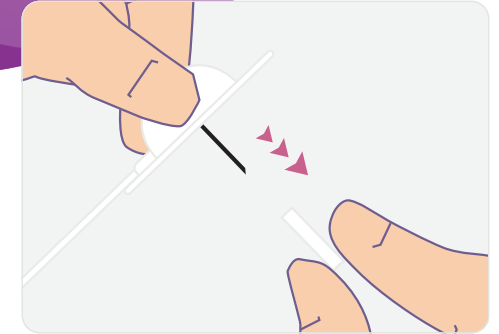

**Step 2.**  
Gently twist and pull to remove the needle guard.

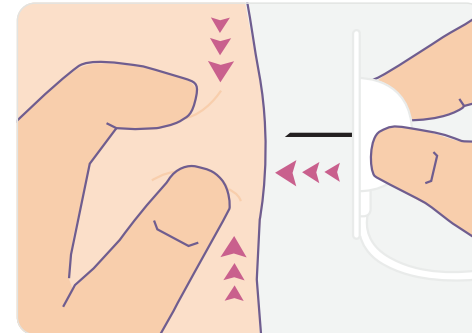

**Step 3.**  
Pinch the skin with one hand and insert the Neria™ infusion set vertically.

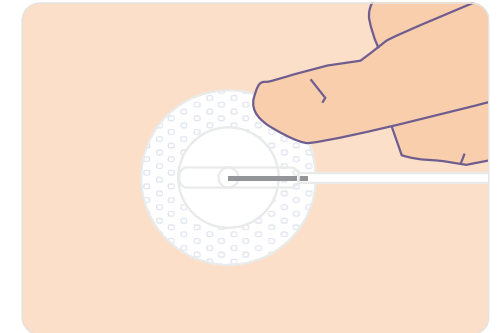

**Step 4.**  
Press the adhesive to secure the Neria™ infusion set to the skin. Check the infusion site frequently.

## DISCLAIMER

Please note that this guide only illustrates some of the steps to follow when inserting a Neria™ infusion set and it is not a substitute for reading the full instructions for use that comes with the product. When using the product for the first time, do so in the presence of your healthcare professional.

AP-68003-GBL-ENG-v1  
© 2024 Convatec

Neria is a trademark of Unomedical A/S. The Convatec name, Hug icon and strapline are trademarks of Convatec.