



neria™ guard infusion sets

neria™ guard is a soft cannula infusion set with an integrated insertion device for simple insertions by the touch of a button. A retractable needle may eliminate accidental needle sticks and increase insertion technique comfort.

Product Specifications

| | |
|---------------------------------|--------------------------|
| Cannula: | Soft |
| Insertion angle: | 90 degrees (straight in) |
| Disconnection: | Yes, at site |
| Introducer needle gauge: | G27 |
| Soft cannula diameter: | 0.68 mm (≈ G23) |

| | |
|--------------------------|--|
| Adhesive: | Built-in, skin friendly non-woven polyester, acrylic adhesive |
| Needle safety: | Yes, passive (Needle not visible before, during and after insertion) |
| Insertion device: | Yes, incorporated in the product |

| Soft cannula lengths | Tubing lengths | Priming volumes |
|----------------------|-----------------------|---|
| 6 and 9 mm | 12, 60, 80 and 110 cm | 12 cm ~ 0.04 ml 60 cm ~ 0.10 ml 80 cm ~ 0.12 ml 110 cm ~ 0.15 ml |

The neria™ guard infusion sets are sold in boxes containing 10 pieces. Separate cannulae and tubing parts are available in boxes containing 10pcs/box.

neria™ guard infusion set user steps

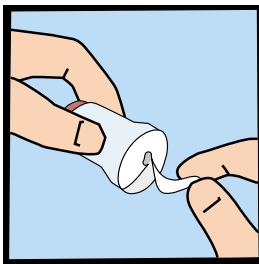

- 1.** Pull gently to remove the paper from the adhesive tape.

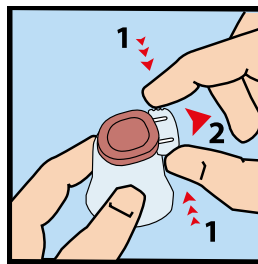

- 2.** Remove the safeguard from the insertion device by gently squeezing the sides of the safeguard and pulling it straight out.

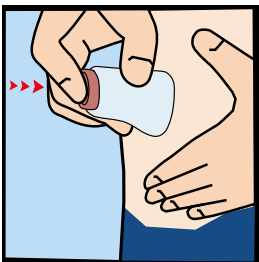

- 3.** Position the insertion device on the skin and press the red activation button completely down to insert the infusion set.

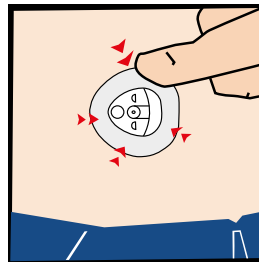

- 4.** Press the adhesive tape onto the skin.

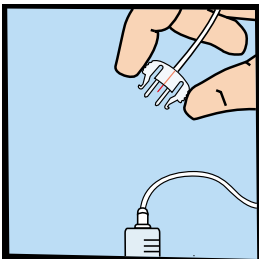

- 5.** Connect to the pump and prime the tubing according to instructions provided by the pump manufacturer.

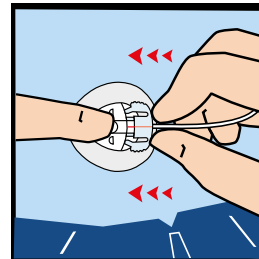

- 6.** Place a finger on the cannula housing while pushing the site connector straight in until you hear a "click".